

Soils Map

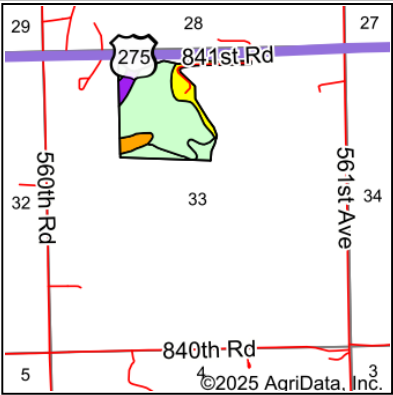

State: **Nebraska**
County: **Stanton**
Location: **33-24N-1E**
Township: **Spring Branch**
Acres: **57**
Date: **6/16/2025**

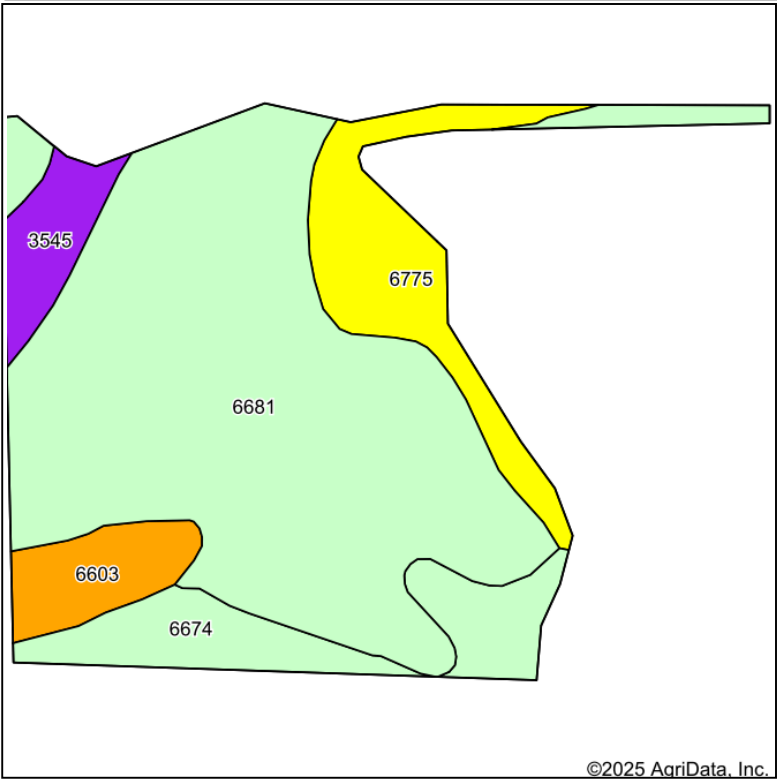

Soils data provided by USDA and NRCS.

©2025 AgriData, Inc.

© AgriData, Inc. 2023 www.AgriDataInc.com

| Area Symbol: NE167, Soil Area Version: 24 | | | | | | | | | | | | |
|---|---|-------|------------------|-------------|------------------|--------------|--------------------------------|------|------------------|---------------|-----------------------|-------------------|
| Code | Soil Description | Acres | Percent of field | SRPG Legend | Non-Irr Class *c | Irr Class *c | Range Production (lbs/acre/yr) | SRPG | *n NCCPI Overall | *n NCCPI Corn | *n NCCPI Small Grains | *n NCCPI Soybeans |
| 6681 | Crofton silt loam, 17 to 30 percent slopes, eroded | 36.88 | 64.7% | | Vle | | 2820 | | 38 | 38 | 31 | 36 |
| 6674 | Crofton silt loam, coarse, 8 to 17 percent slopes, eroded | 7.46 | 13.1% | | IVe | | 3708 | | 58 | 55 | 55 | 57 |
| 6775 | Nora-Crofton complex, 2 to 6 percent slopes, eroded | 6.84 | 12.0% | | Ile | IIle | 3275 | 61 | 68 | 62 | 59 | 68 |
| 6603 | Alcester silty clay loam, 2 to 6 percent slopes | 3.17 | 5.6% | | Ile | IIle | 3498 | 73 | 75 | 74 | 66 | 72 |
| 3545 | Hobbs silt loam, channeled, 0 to 2 percent slopes, frequently flooded | 2.65 | 4.6% | | VIw | | 3340 | 55 | 41 | 41 | 26 | 39 |
| Weighted Average | | | | | 5.04 | *- | 3052.7 | 13.9 | *n 46.4 | *n 45.2 | *n 39.2 | *n 44.7 |

*n: The aggregation method is "Weighted Average using all components"
*c: Using Capabilities Class Dominant Condition Aggregation Method
*- Irr Class weighted average cannot be calculated on the current soils data due to missing data.

Soils data provided by USDA and NRCS.