

Soils Map

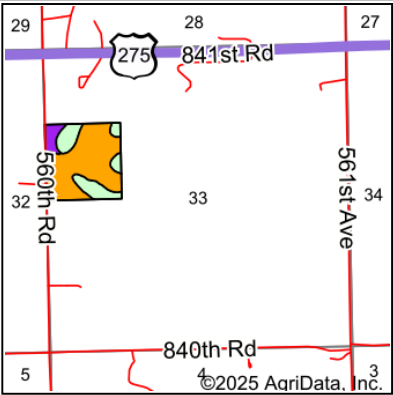

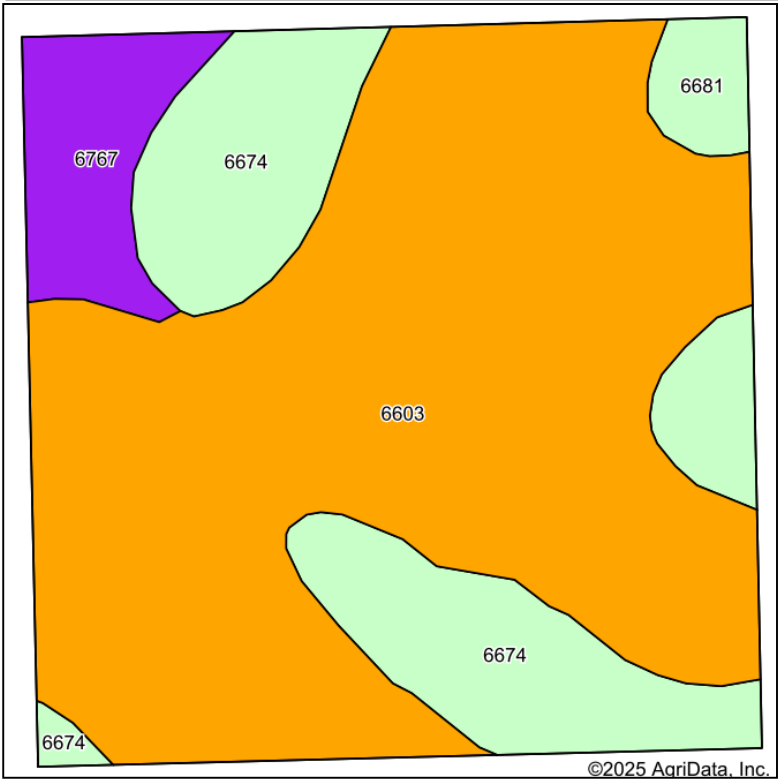



State: **Nebraska**
County: **Stanton**
Location: **33-24N-1E**
Township: **Spring Branch**
Acres: **40.18**
Date: **6/16/2025**



Maps Provided By:
 **surety**
CUSTOMIZED ONLINE MAPPING
© AgriData, Inc. 2023 www.AgriDataInc.com



Soils data provided by USDA and NRCS.

Area Symbol: NE167, Soil Area Version: 24													
Code	Soil Description	Acres	Percent of field	SRPG Legend	Non-Irr Class *c	Irr Class *c	Range Production (lbs/acre/yr)	SRPG	*n NCCPI Overall	*n NCCPI Corn	*n NCCPI Small Grains	*n NCCPI Soybeans	
6603	Alcester silty clay loam, 2 to 6 percent slopes	27.35	68.1%		Ile	IIIe	3498	73	75	74	66	72	
6674	Crofton silt loam, coarse, 8 to 17 percent slopes, eroded	9.12	22.7%		IVe		3708		58	55	55	57	
6767	Nora silty clay loam, 6 to 11 percent slopes	2.77	6.9%		IIIe	IVe	3200	59	74	63	62	73	
6681	Crofton silt loam, 17 to 30 percent slopes, eroded	0.94	2.3%		VIe		2820		38	38	31	36	
Weighted Average					2.62	*-	3509.3	53.8	*n 70.2	*n 68.1	*n 62.4	*n 67.8	

*n: The aggregation method is "Weighted Average using all components"
*c: Using Capabilities Class Dominant Condition Aggregation Method
*- Irr Class weighted average cannot be calculated on the current soils data due to missing data.

Soils data provided by USDA and NRCS.