

Soils Map

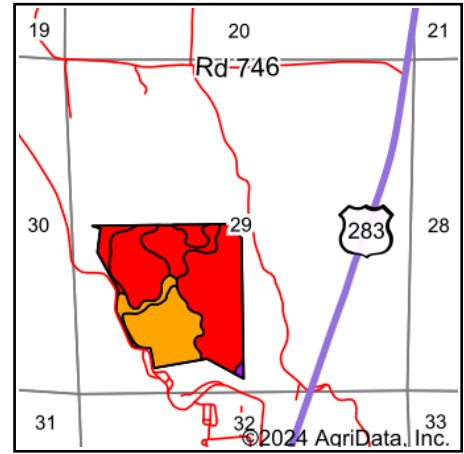

State: **Nebraska**
 County: **Gosper**
 Location: **29-8N-22W**
 Township: **Bethel**
 Acres: **96.29**
 Date: **10/31/2024**

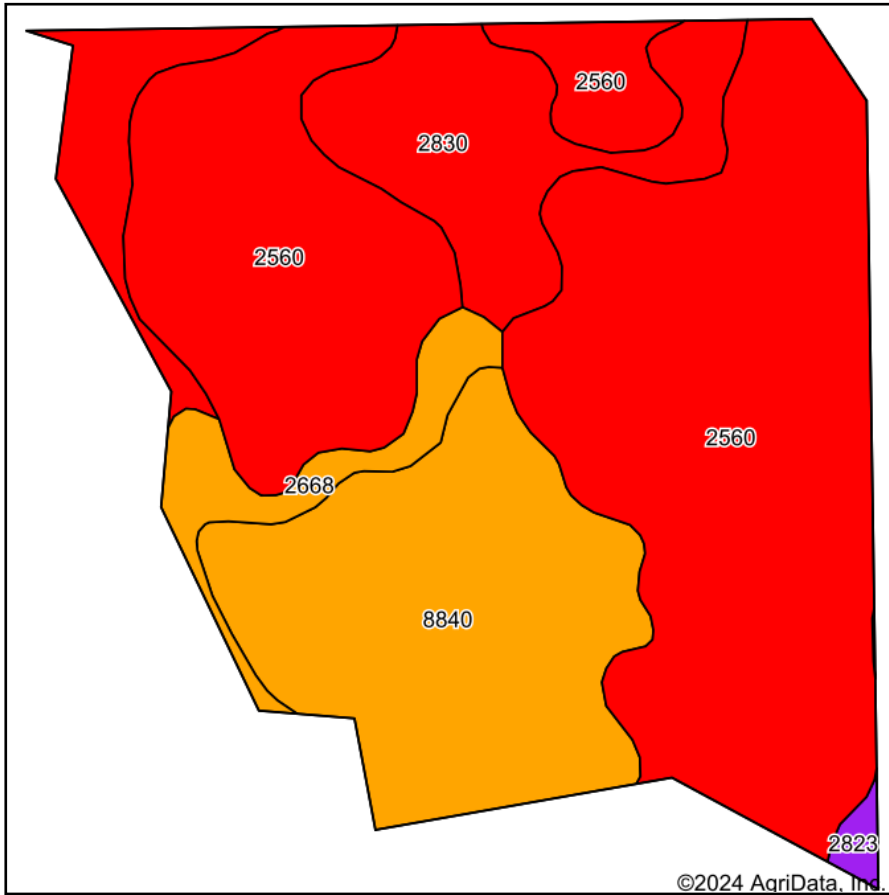

Maps Provided By:



© AgriData, Inc. 2023

www.AgriDataInc.com



Area Symbol: NE073, Soil Area Version: 22

Code	Soil Description	Acres	Percent of field	SRPG Legend	Non-Irr Class *c	Irr Class *c	Range Production (lbs/acre/yr)	SRPG	Alfalfa hay Tons	Alfalfa hay Irrigated Tons	Corn Bu	Corn Irrigated Bu	Grain sorghum Bu	Grain sorghum Irrigated Bu	Winter wheat Bu	*n NCCPI Overall	*n NCCPI Co
2560	Coly-Uly-Hobbs silt loams, 3 to 60 percent slopes	55.73	57.9%		Vlle		2985	45									33
8840	Hall silt loam, 0 to 1 percent slopes	21.51	22.3%		llc	lw	2980	71	3	7	48	157	58	118	42		73
2830	Uly-Coly silt loams, 11 to 30 percent slopes	14.43	15.0%		Vle		2870	32									62
2668	Holdrege silt loam, 1 to 3 percent slopes	4.05	4.2%		lle	lle	3661	71									78
2823	Uly silt loam, 11 to 17 percent slopes, eroded	0.57	0.6%		Vle		3115	57									60
Weighted Average					5.52	*-	2995.9	50	0.7	1.6	10.7	35.1	13	26.4	9.4	*n 48.3	*n

*n: The aggregation method is "Weighted Average using all components"

*c: Using Capabilities Class Dominant Condition Aggregation Method

*-: Irr Class weighted average cannot be calculated on the current soils data due to missing data.